

Baton Security Products, Inc

11521 Salinas Avenue,
Garden Grove, California 92843, USA
Tel:(714) 590 6969 Fax:(714) 590 6960
Email address : Sales@batonlockusa.com

baton[®]
Security Products
www.batonlockusa.com

Form QF-E12

Quotation Ref # _____
 Order PO# _____

Euro Profile Cylinders with option Turns

Dear Baton user:

Please refer to the line drawings showed, mark the necessary info below and return to us for quote:

- 1 Type of cylinder
- 2 5-pin or 6-pin. See note.
- 3 Length of A side(exterior)
- 4 Length of B side(interior)
- 5 Finish of A side(exterior)
- 6 Finish of B side(interior)
- 7 Check here for Type PT

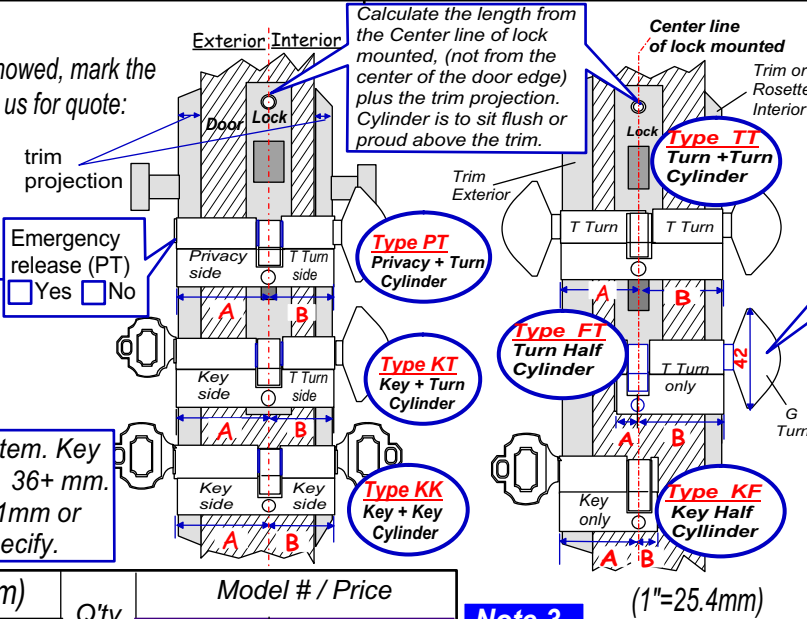

Emergency release (PT)
 Yes No

Note 1

- "Schlage-C" keyway 5-pin system. Key side must be 31mm, 36mm or 36+ mm.
- 6-pin is available for 36mm, 41mm or 41+mm at key side. Please specify.

Note 2

Type ET, PT & KT come with G style Turn as standard except otherwise specify/ order with below options: (check only if apply)

Ship with G turn removed.

The following T turns are optional. Extra surcharge apply

Ship with thin D turn (10B, 15, 26D, 3, 3N, 4)

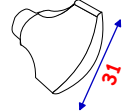

Ship with narrow G1 turn (10B, 19, 3, 3N, 4)

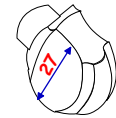

Ship with Oval H turn (10B, 19, 3, 3N, 4)

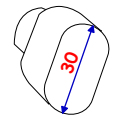

Note 3

Key cylinder is supplied with 2 keys / random codes per cylinder as standard. Check here if additional keys or keying service is required.

- Key differently, total _____ keys per cylinder
- Key alike, total _____ keys
- Master keying, _____ keys per cylinder & _____ Master keys
-

1 Cylinder type	2 5-pin or 6-pin	3 size (mm)		Q'ty	Model # / Price	
		4 A side	4 B side		Net/ea	Total
1		5 size	6			
		5 finish				
2		5 size	6			
		5 finish				
3		5 size	6			
		5 finish				
4		5 size	6			
		5 finish				
5						
6						
7						
8						
9						
10						

Lead time : about _____ working days

Contact name: _____
Firm: _____
Add: _____
City: _____
St _____ zip _____ Tel: _____ - _____
Email: _____

Caution !!

The Euro Profile Cylinder uses the key tip to integrate / drive the internal plunger to work with the cylinder cam. When key is duplicated, make sure that the key tip is made to the same shape and length as the original 'Baton' key furnished. Failure to follow these specifications could wear out the construction and cause malfunction.

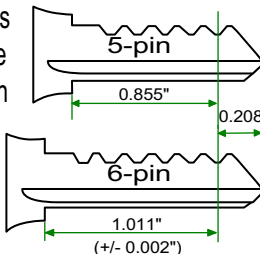

Custom made products are constructed with the specifications requested. Baton warrants that the product will be functioning according to all the specifications and operating parameters of our original products line. No guarantee exists on product functions within specifications of other's make. ****Deposit required for custom made and refinish items. No return and No refund.****